

# **AKRA**<sup>®</sup> LUX Greca 4

**HIGHLY TRANSLUCENT PROFILED  
POLYCARBONATE INSULATING SHEET**

## **ASSEMBLY INSTRUCTIONS**

Rev. 00

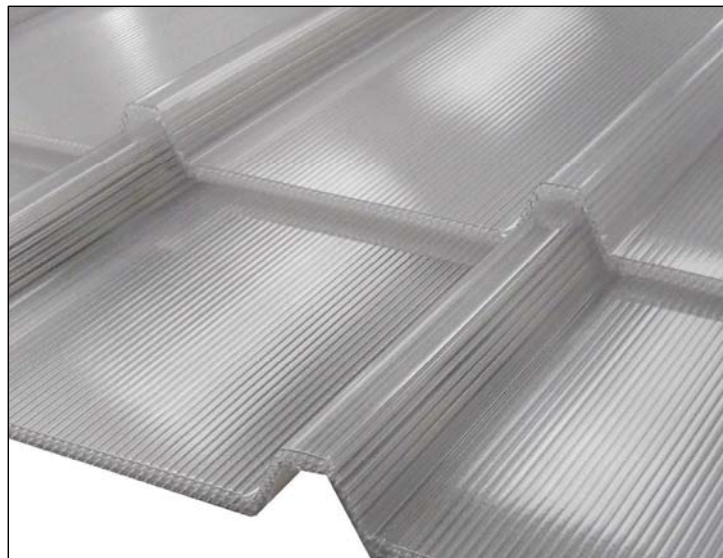

**AKRAPLAST**<sup>®</sup>  
AKRAPLAST Sistemi S.p.A.

**TECHNICAL DATA**

**SHEET SECTION**

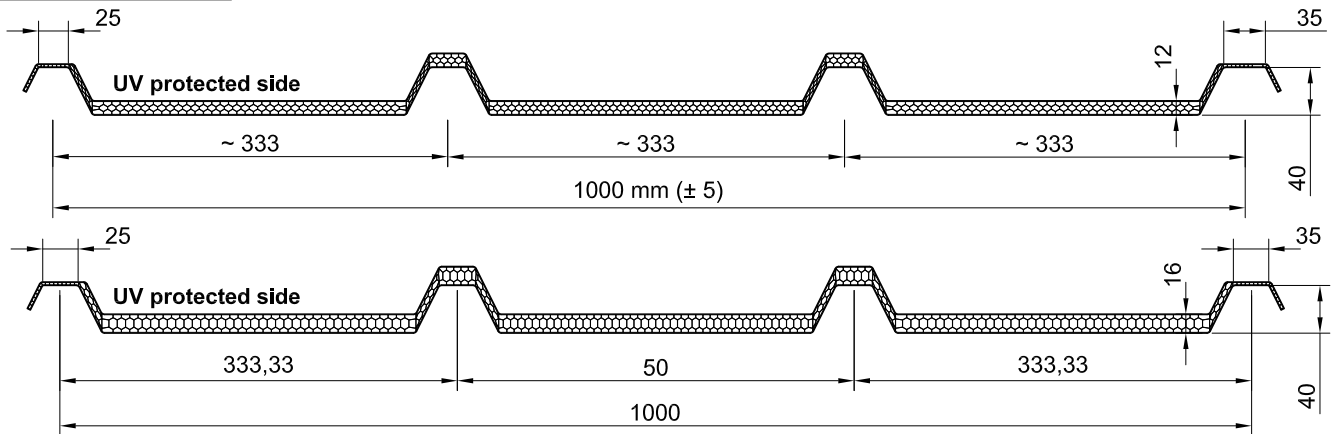

**TECHNICAL DATA**

Panel thickness	12 mm	16 mm
Number of waves	4	
Pitch of waves	~333 mm	
Modular width	~1000 ± 5 mm (sheet width)	
Standard length	8000 mm	
Length on request	max. 13500 mm	
Standard width lateral profiles	25 - 35	
Width lateral profiles on request	to evaluate depending on application	
Curved sheet	R = ~3500 mm - ~6000 mm	
Colour	trasparent - opaline	
Weight	2,6 kg/m <sup>2</sup>	2,8 kg/m <sup>2</sup>
UV protection	coextruded on external side	
Closure of borders	thermosealed	
Fire classification EN 13501-1	B s1 d0	
Light transmissison	transparent ~61% opaline ~45%	transparent ~55% opaline ~40%
Thermal transmission [U]	2,25 W/m <sup>2</sup> K	1,99 W/m <sup>2</sup> K
Thermal expansion	0,065 mm/m °K	
Temperature range	-40 / +120 °C	

**SPECIFICATION TEXT**

(Choose between the alternatives marked with ●)

● Flat rooflight; ● flat roof; ● domed roof  
realised with profiled sheets in UV protected multi-wall ploycarbonate, with thermosealed borders, type **AKRALUX Greca 4** by Akraplast Sistemi,

- Thickness 12 mm, module 1000 mm, honeycomb, thermal insulation U=2,25 W/m<sup>2</sup>K
- Thickness 16 mm, module 1000 mm, honeycomb, thermal insulation U=1,99 W/m<sup>2</sup>K
- Colours ● transparent; ● opaline; ● others .....

Inlays in PE foam, gaskets and what else is necessary for the tightness at the borders.

**ADMITTED LOADS**

**MAXIMUM ADMITTED LOAD WITH UNIFORM DISTRIBUTION**

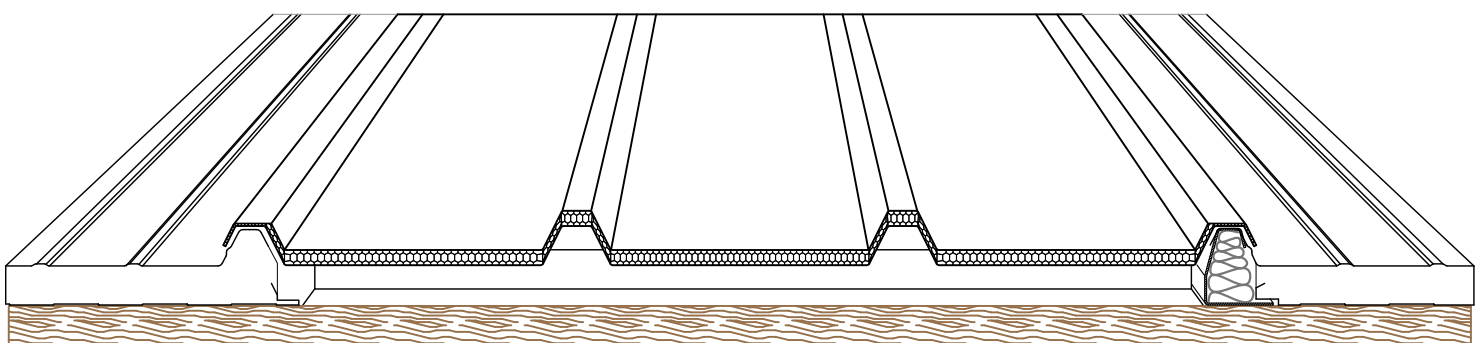
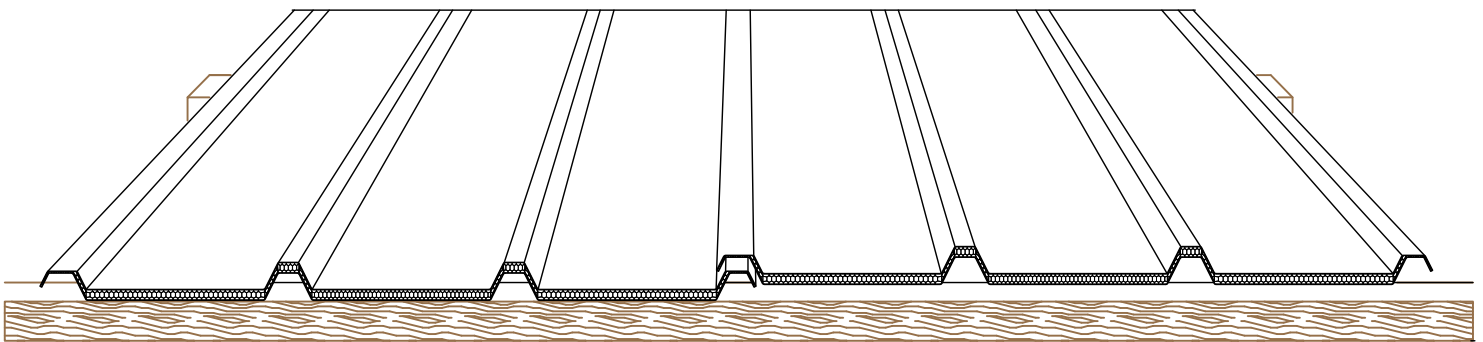
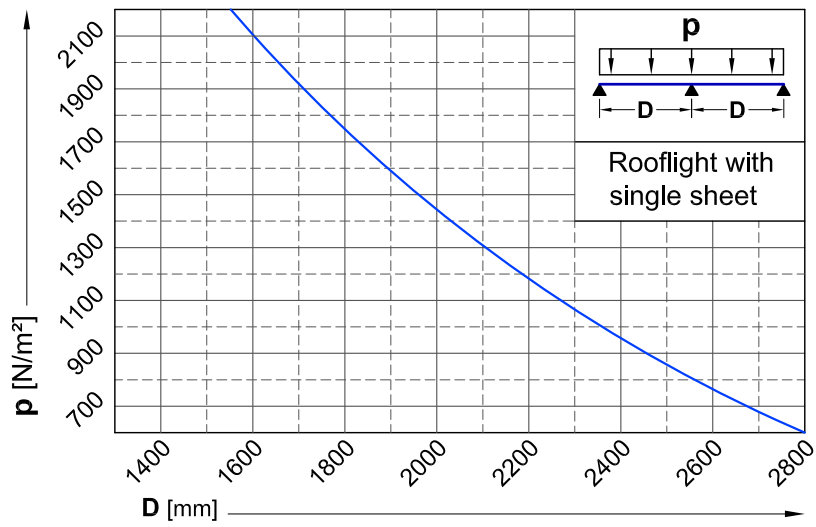
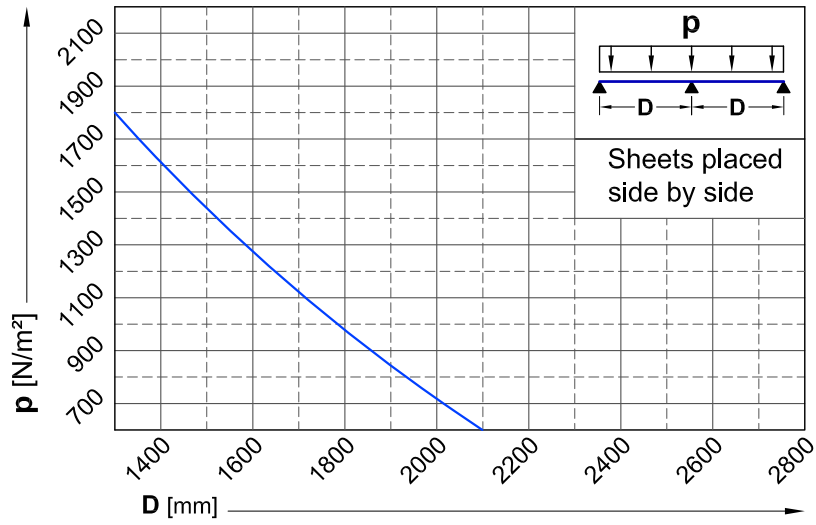

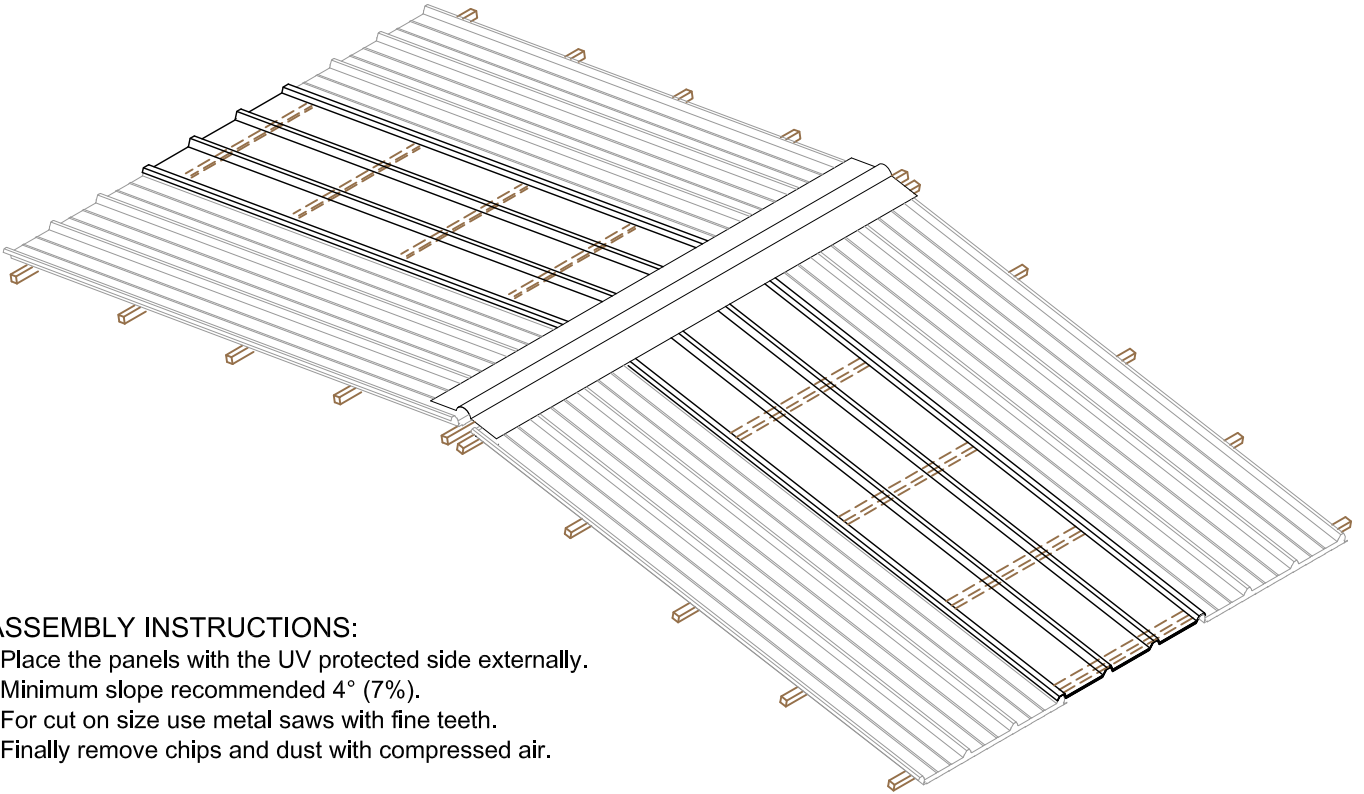

**ASSEMBLY INSTRUCTIONS:**

- Place the panels with the UV protected side externally.
- Minimum slope recommended 4° (7%).
- For cut on size use metal saws with fine teeth.
- Finally remove chips and dust with compressed air.

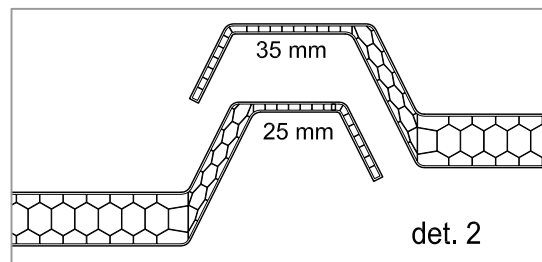
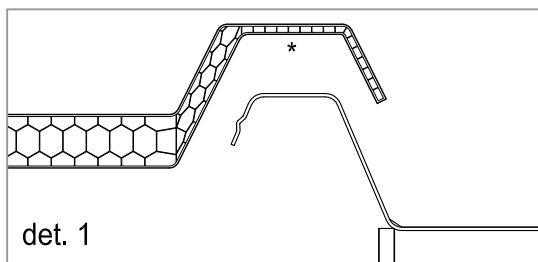
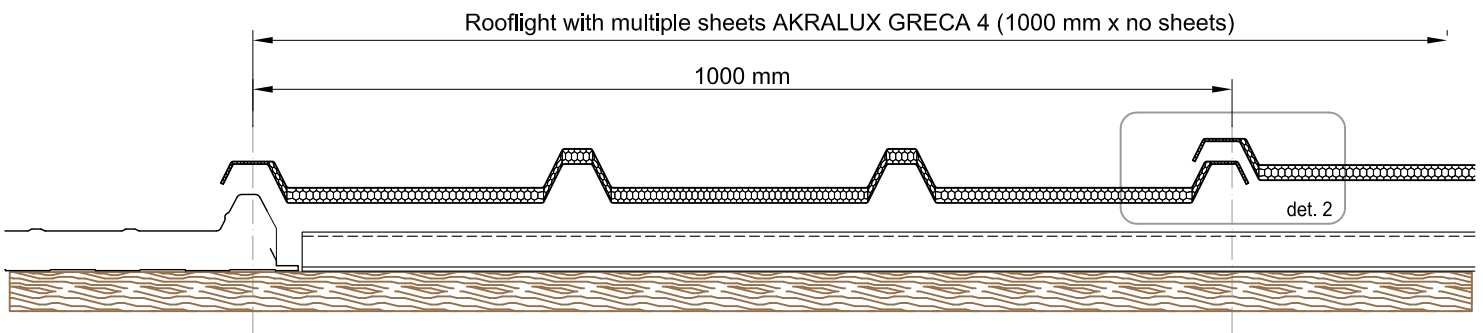
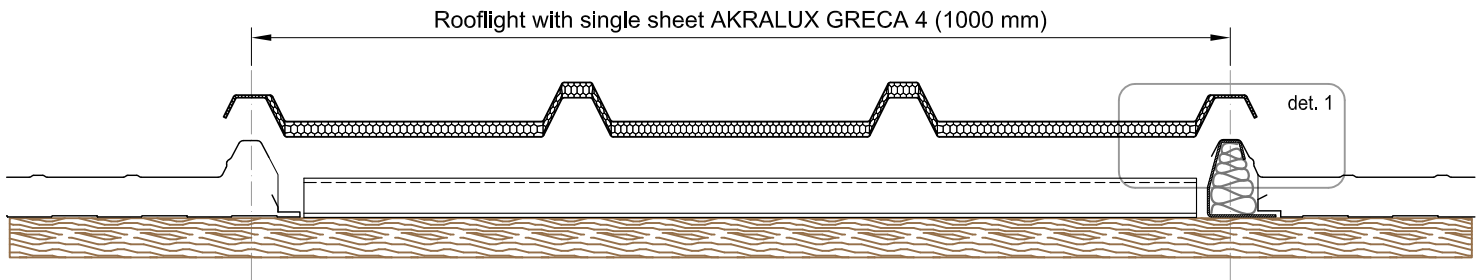

\* changeable for perfect placement on the panel

**ROOFLIGHT FROM RIDGE TO EAVES**

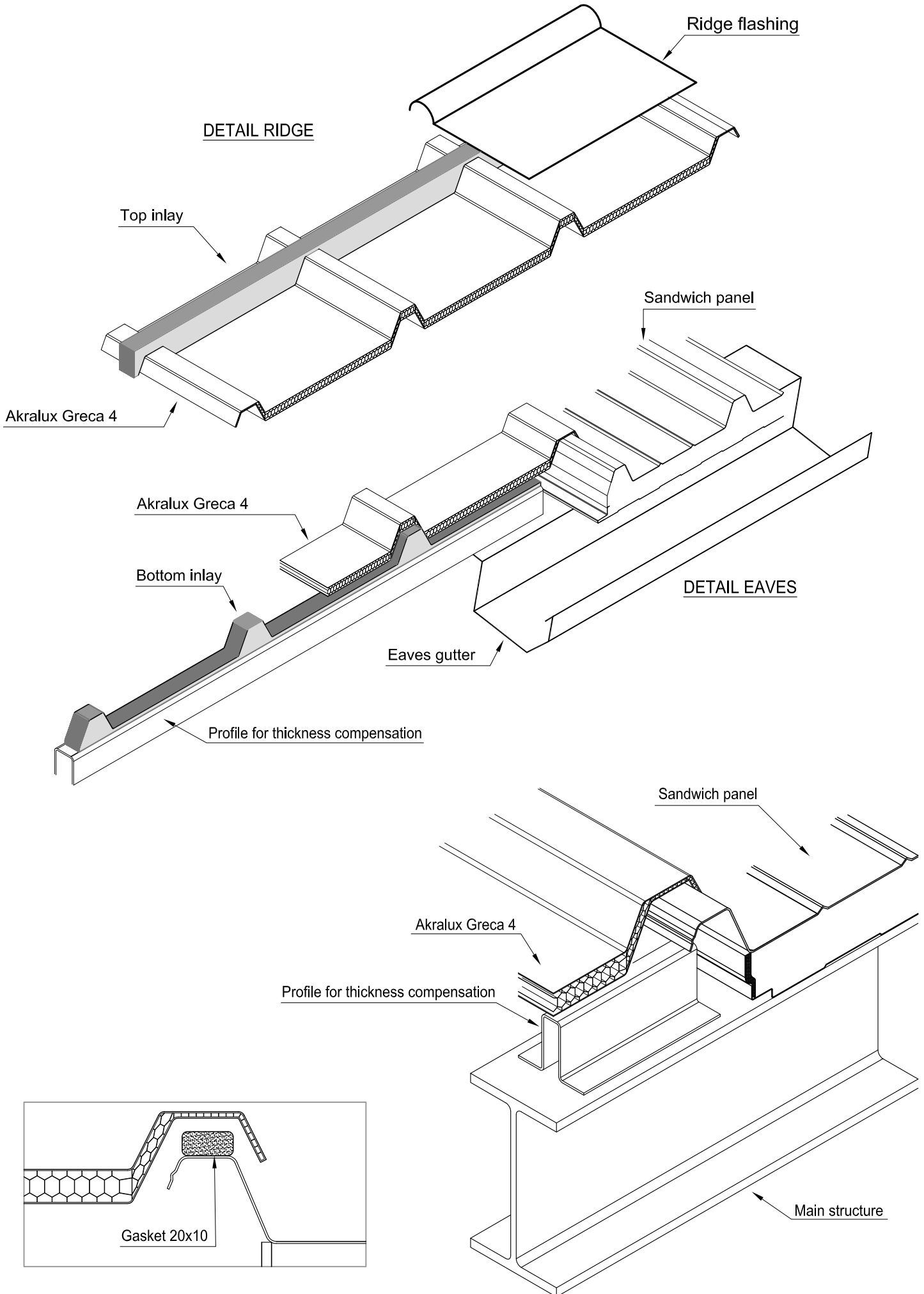

**ROOFLIGHT FROM RIDGE TO EAVES**

OVERLAP ON ROOF

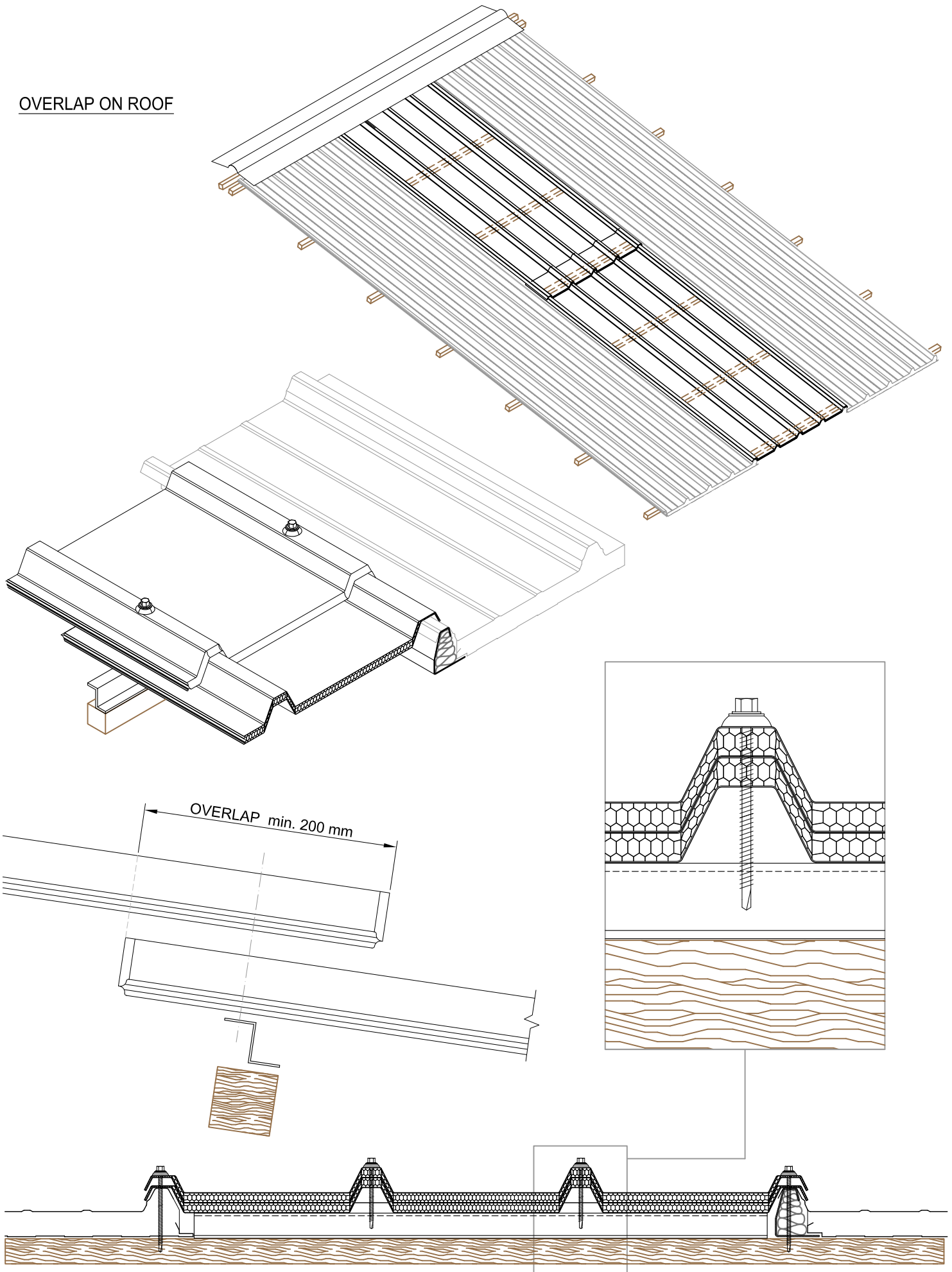



**ROOFLIGHT FROM RIDGE TO EAVES**

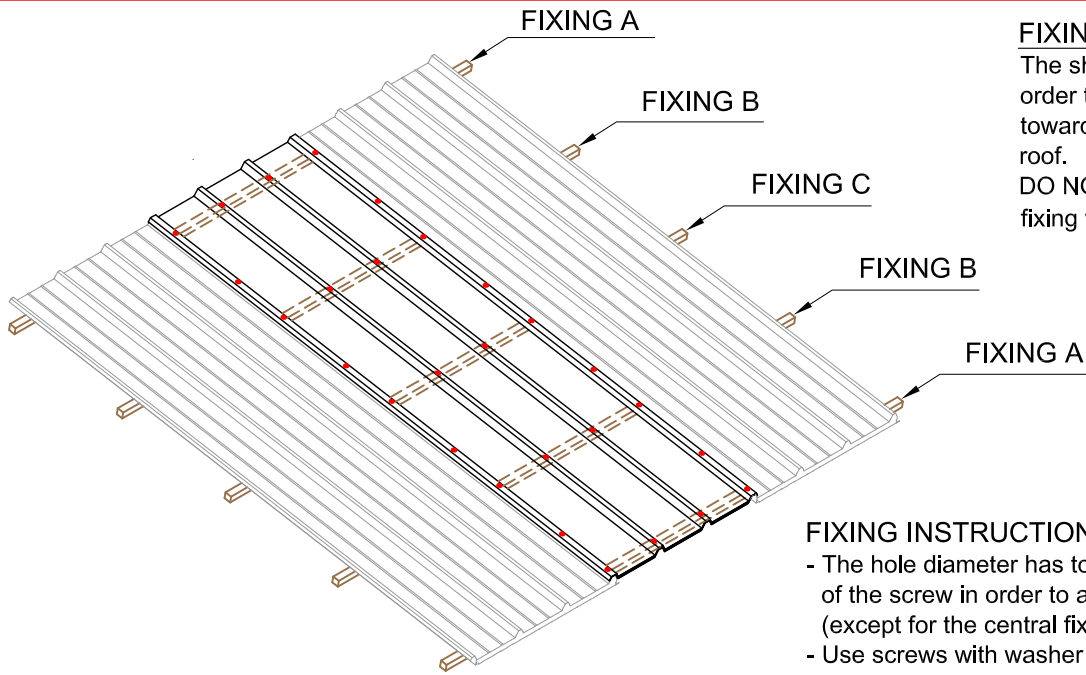

**FIXING C:**  
The sheet has to be fixed centrally in order to allow distribution of expansion towards the top and the bottom of the roof.  
DO NOT oval hole in which the fixing will be done.

**FIXING INSTRUCTIONS:**

- The hole diameter has to be bigger than the diameter of the screw in order to allow thermal expansion (except for the central fixing C).
- Use screws with washer and gasket and the special shaped caps.
- Fixing has to be done in position of every support.
- Intermediate fixings have to be done at a distance of approx. 80 cm.

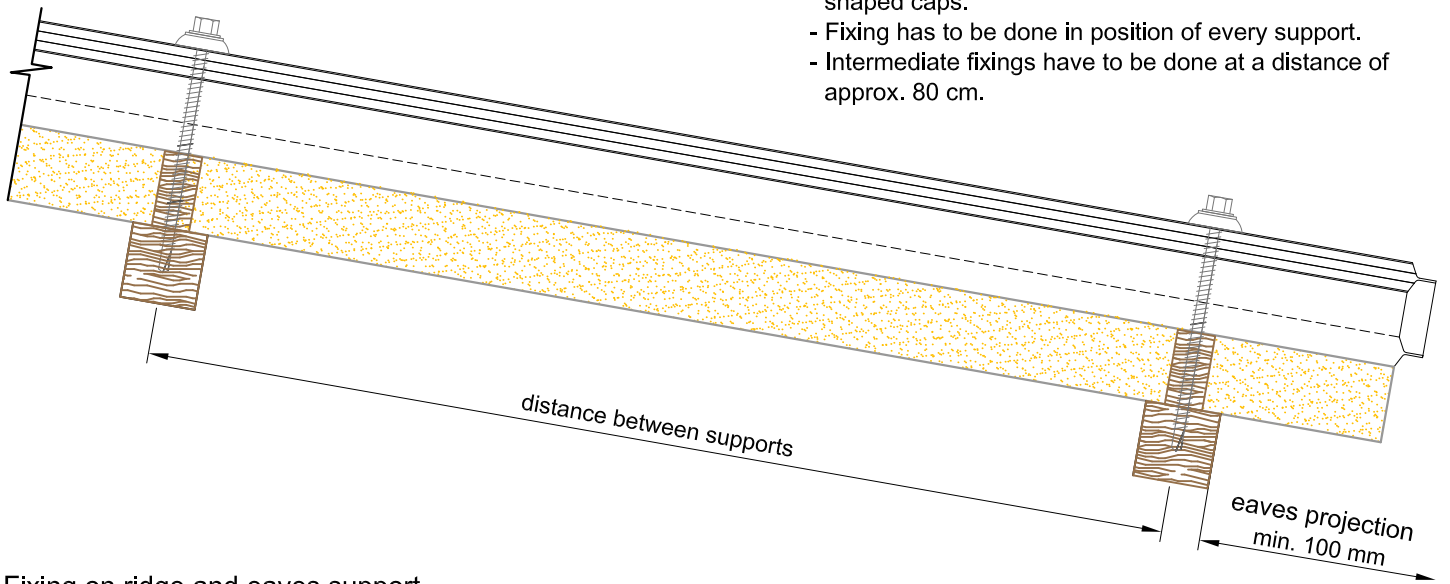

Fixing on ridge and eaves support



Fixing on intermediate supports

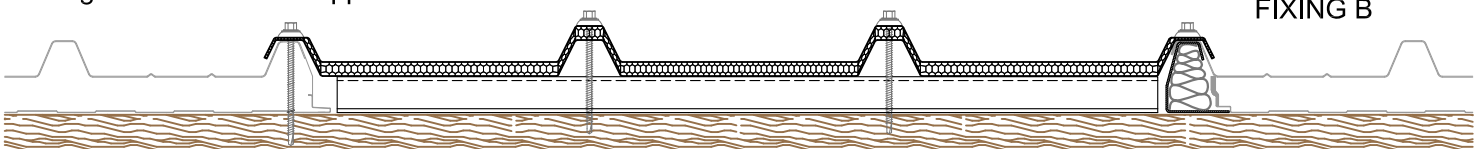

FIXING WITH CAP

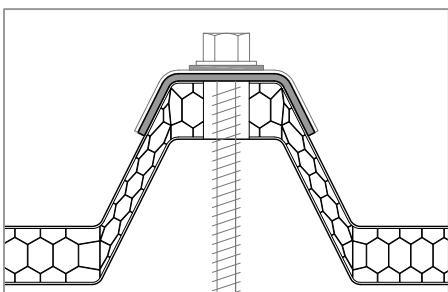

FIXING WITH SCREW AND WASHER BAZ

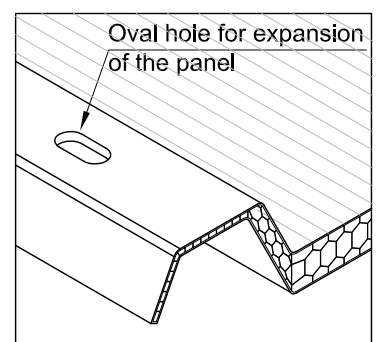
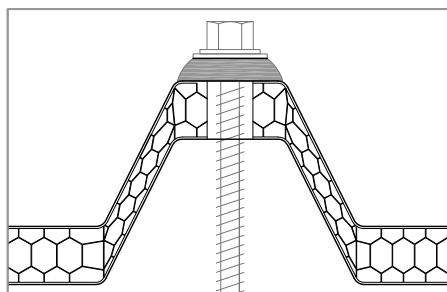

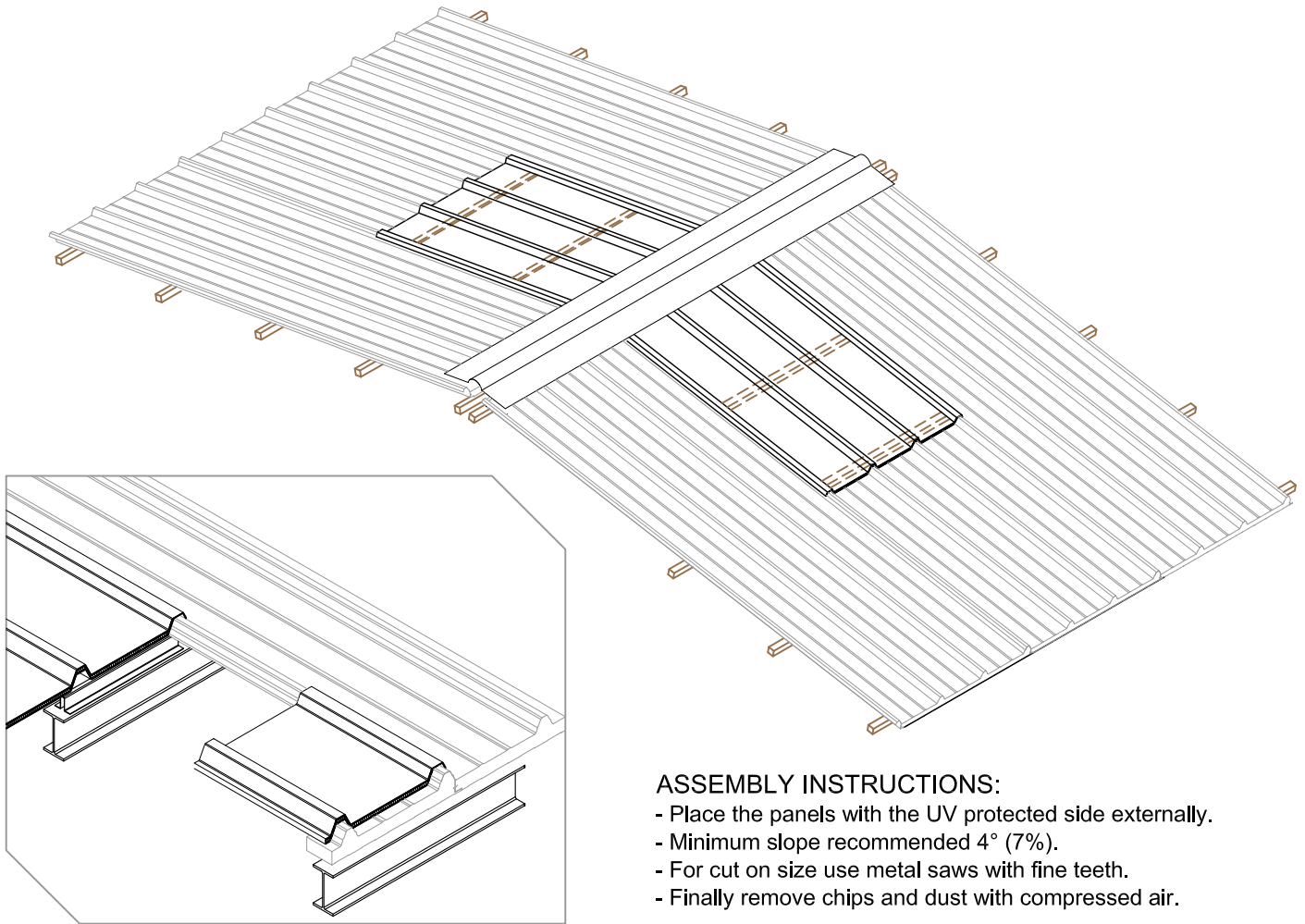

**ASSEMBLY INSTRUCTIONS:**

- Place the panels with the UV protected side externally.
- Minimum slope recommended 4° (7%).
- For cut on size use metal saws with fine teeth.
- Finally remove chips and dust with compressed air.

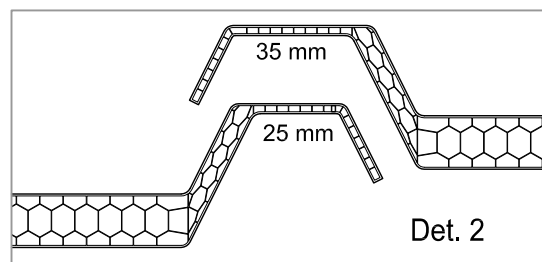
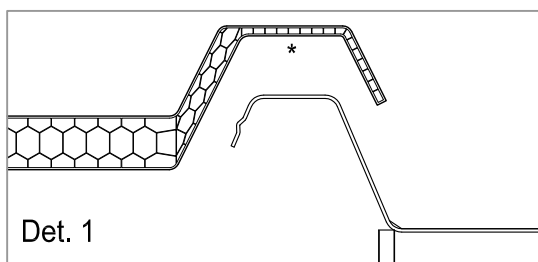
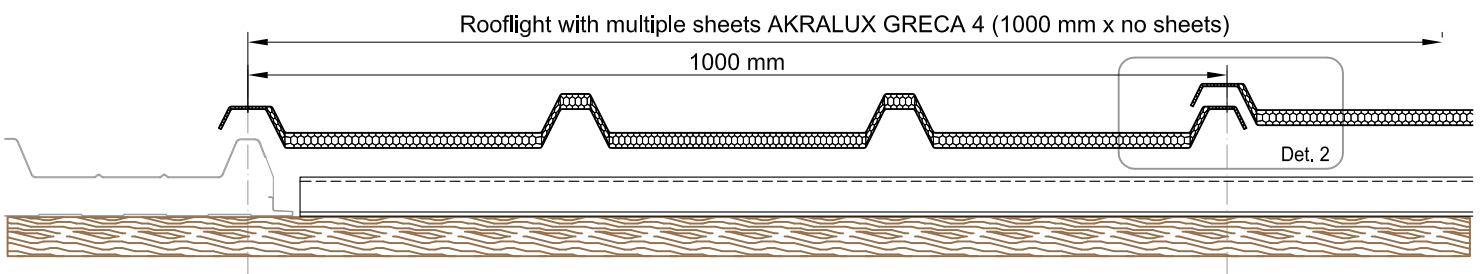
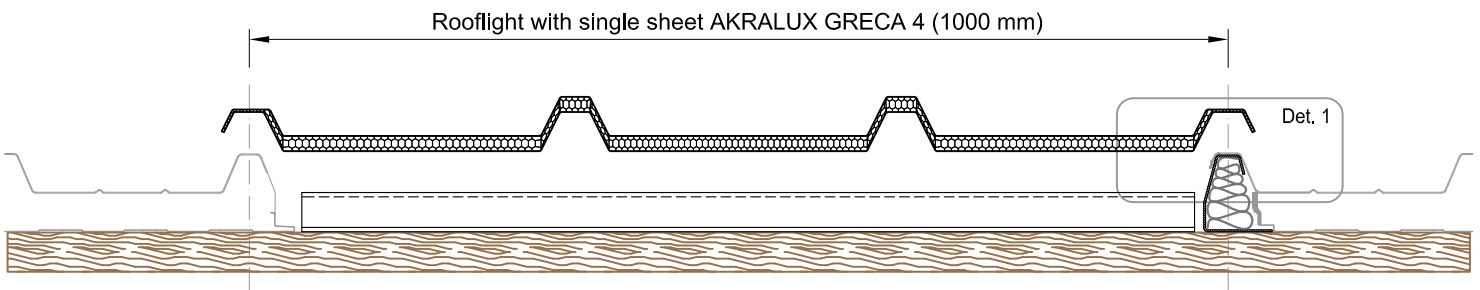

\* changeable for perfect placement on the panel



**ROOFLIGHT FROM RIDGE TO HALF ROOF**

**FIXING INSTRUCTIONS:**

- Use screws with washer and gasket and the special shaped caps.
- The hole diameter has to be bigger than the diameter of the screw in order to allow thermal expansion (except for the central fixing B).
- Fixing has to be done in position of every support.
- Intermediate fixings have to be done at a distance of approx. 80 cm.

**Overlapping between Akralux Greca 4 and sandwich panel**

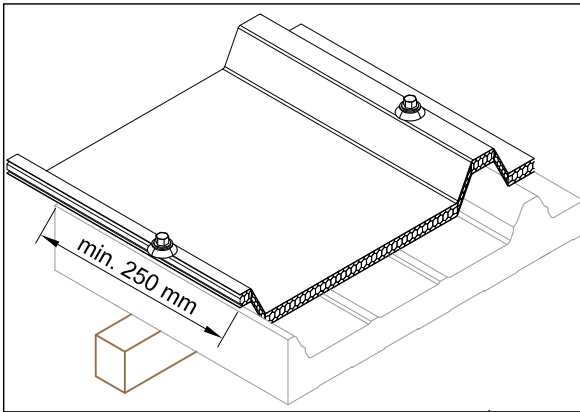

Gasket for compensation

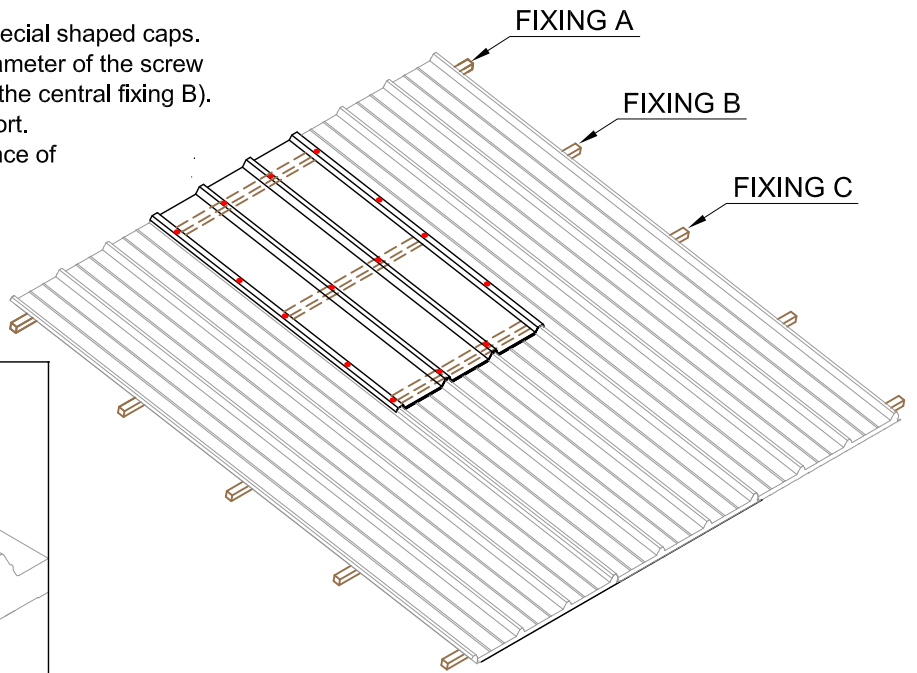
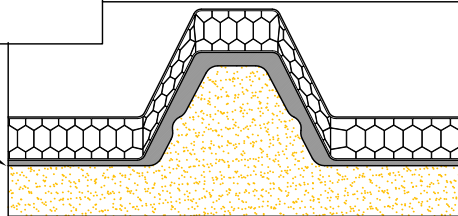

**FIXING B:**

The sheet has to be fixed centrally in order to allow distribution of expansion towards the top and the bottom of the roof.  
**DO NOT** oval hole the hole in which the fixing will be done.

Fixing on ridge support

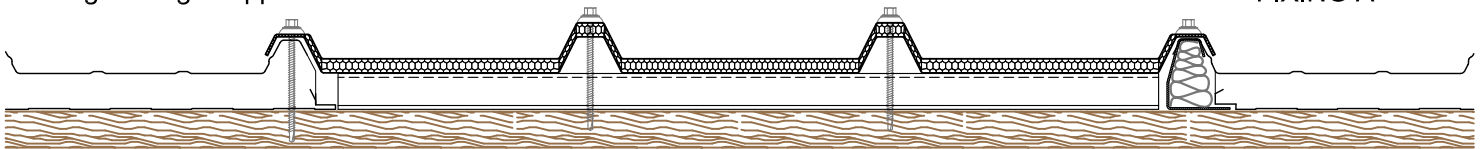

Fixing on intermediate supports

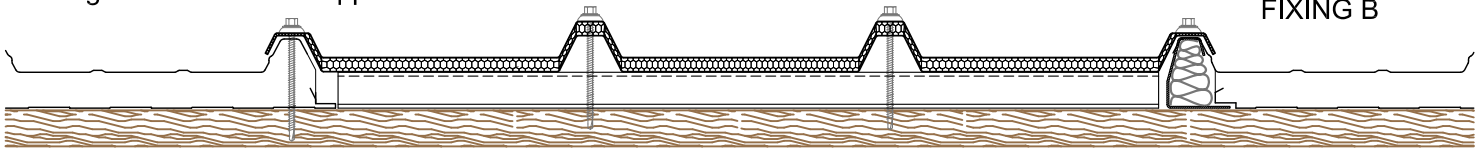

Fissaggio sul sormonto con il pannello sandwich

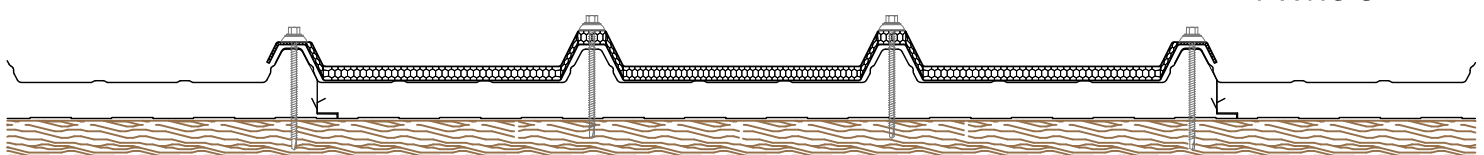

FIXING WITH CAP

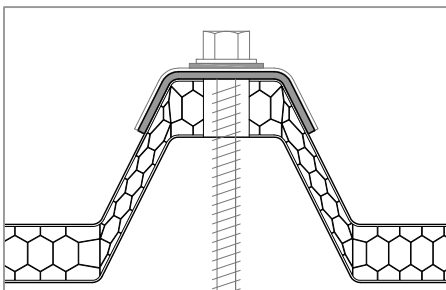

FIXING WITH SCREW AND WASHER BAZ

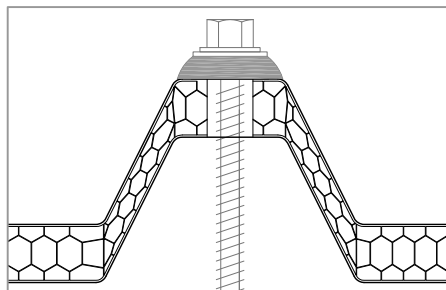

Oval hole for expansion of the panel

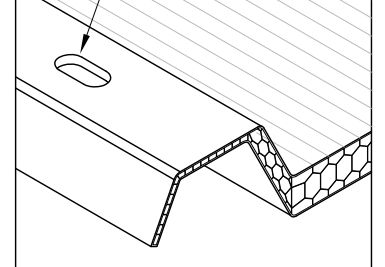

**Liability Clause:** all information and technical advice given are made in good faith and based on the best of our knowledge; but having no control over the use of their material, we accept no responsibility for their applications. These indications do not exempt the customer from its controls to determine compliance of materials and installation procedures to their needs and standards.  
AKRAPLAST Sistemi SpA reserves the right to change specifications at any time.



**AKRAPLAST Sistemi S.p.A.**

I - 20026 Novate Milanese (Mi) - via Cascina del Sole, 70  
Tel: (+39) 02 35 13 91 1 - Fax: (+39) 02 35 13 91 50  
E-mail: [info@akraplast.com](mailto:info@akraplast.com) - [www.akraplast.com](http://www.akraplast.com)